

# WebFOCUS

WebFOCUS Release Guide  
Release 8205.16

October 21, 2020

Active Technologies, EDA, EDA/SQL, FIDEL, FOCUS, Information Builders, the Information Builders logo, iWay, iWay Software, Parlay, PC/FOCUS, RStat, Table Talk, Web390, WebFOCUS, WebFOCUS Active Technologies, and WebFOCUS Magnify are registered trademarks, and DataMigrator and Hyperstage are trademarks of Information Builders, Inc.

Adobe, the Adobe logo, Acrobat, Adobe Reader, Flash, Adobe Flash Builder, Flex, and PostScript are either registered trademarks or trademarks of Adobe Systems Incorporated in the United States and/or other countries.

Due to the nature of this material, this document refers to numerous hardware and software products by their trademarks. In most, if not all cases, these designations are claimed as trademarks or registered trademarks by their respective companies. It is not this publisher's intent to use any of these names generically. The reader is therefore cautioned to investigate all claimed trademark rights before using any of these names other than to refer to the product described.

Copyright © 2019, by Information Builders, Inc. and iWay Software. All rights reserved. Patent Pending. This manual, or parts thereof, may not be reproduced in any form without the written permission of Information Builders, Inc.

# Contents

---

<b>1. WebFOCUS Release Information .....</b>	<b>5</b>
Functionality .....	5
Browser Information .....	6
Web Browsers.....	6
8.2.x Notes.....	7
Mobile Browser Information.....	9
Accessibility Compliance.....	10
WebFOCUS Client Supported Operating Systems .....	10
WebFOCUS Support Statement for Java Platform, Standard Edition (Java SE) .....	11
WebFOCUS Application Server Minimum JVM Version Requirement.....	12
Supported RDBMS and Drivers .....	12
Supported Web and App Servers .....	14
WebFOCUS SOAP Web Services Minimum Axis Version Requirement .....	14
Localization (NLV) and NLS Support .....	14
National Language Support (NLS) .....	15
Localized Version Support (NLV) .....	15
WebFOCUS and Reporting Server .....	15
Language.....	17
WebFOCUS Client and ReportCaster .....	18
App Studio.....	19
WebFOCUS Open Portal Services - Supported Portals .....	19
WebFOCUS and App Studio Release Availability .....	20
WebFOCUS Reporting and Microsoft Office Support .....	22
WebFOCUS Reporting Formats and Microsoft Product Association.....	22
WebFOCUS EXL2K and PPT Formats and Microsoft Office Suite Support.....	23
Microsoft Office 2003 Support.....	24
WebFOCUS EXL2K and PPT Formats and Microsoft Office Viewer Products Support.....	24
Microsoft Office 365 Support.....	24
Usage Consideration When Using Hyperlinks to Run WebFOCUS Reports .....	25
WebFOCUS DOC Format.....	25
Recommended Reading.....	25
Additional Resources .....	26

**2. WebFOCUS 8205 Release Considerations .....27**

    Active Technologies .....27

    App Studio ..... 28

    Autoprompt .....32

    Charts and Graphs .....33

        X-Axis Title Changes for Matrix Charts.....33

    InfoAssist ..... 35

    National Language Support ..... 35

    WebFOCUS Infrastructure and Security ..... 35

    WebFOCUS Language ..... 42

        HTML Report Output.....42

        Prefix Operators PCT., RPCT., and PCT.CNT.....44

        DATEFNS Parameter.....45

        Limit on Objects Removed .....45

## WebFOCUS Release Information

---

This topic describes relevant release information for WebFOCUS Release 8205.

### In this chapter:

- ☐ [Functionality](#)
  - ☐ [Browser Information](#)
  - ☐ [WebFOCUS Client Supported Operating Systems](#)
  - ☐ [WebFOCUS Support Statement for Java Platform, Standard Edition \(Java SE\)](#)
  - ☐ [Supported RDBMS and Drivers](#)
  - ☐ [Supported Web and App Servers](#)
  - ☐ [WebFOCUS SOAP Web Services Minimum Axis Version Requirement](#)
  - ☐ [Localization \(NLV\) and NLS Support](#)
  - ☐ [WebFOCUS Open Portal Services - Supported Portals](#)
  - ☐ [WebFOCUS and App Studio Release Availability](#)
  - ☐ [WebFOCUS Reporting and Microsoft Office Support](#)
  - ☐ [Additional Resources](#)
- 

### Functionality

The following are functionality support limitations in WebFOCUS Release 8205:

- ☐ Release 8205.14 WF Client installation supports in-place upgrade from versions 8.1.05M and 8.2.x. However, if you are planning to upgrade to the latest release, we recommend you consider upgrading to WebFOCUS 8206, which will be available in early June. Release 8206 will include significant, new enhancements throughout the product line, as well as fixes.
- ☐ Releases prior to 8205.14 are available to customers' new development projects.
- ☐ Accessibility - support limited to HTML and PDF formats. For additional information, see [Accessibility Compliance](#) on page 10.

- ❑ The ReportCaster API functionality DSTBULK is not available.

Please also review the [WebFOCUS 8.2 WebFOCUS and App Studio Consolidated Features](#) statement that provides information on the WebFOCUS Release 8.2 product components, interfaces, and tools that are discontinued or functionally stabilized due to the availability of new or enhanced product components or confirmed usage decline.

## Browser Information

The following topics describe information for the available web and mobile browsers for WebFOCUS Release 8205.

### Web Browsers

- ❑ Information Builders evaluates the browser vendor support policy and certifies new browser versions. See the Microsoft website for information on Internet Explorer, including the [Support for older versions of Internet Explorer ended](#) statement. Information Builders recommends following the usage requirements of the browser vendor to insure your browser is secure and supports the web standards that power current web-based capabilities.
- ❑ For information on certain conditions that can force Internet Explorer to display pages in a document mode different from the one specified in the webpage, see [Internet Explorer Browser Document Compatibility](#).
- ❑ For information on the expected behavior of Internet Explorer (32-bit) on a Windows x64 machine, see the Microsoft TechNet article [Run IE 32bit on Windows 10 X64](#).
- ❑ See the following information published by Mozilla for information on Firefox browser release management:  
[https://wiki.mozilla.org/Release\\_Management/ESR\\_Landing\\_Process](https://wiki.mozilla.org/Release_Management/ESR_Landing_Process)
- ❑ For additional browser, Java Virtual Machine (JVM), and Adobe Reader support information, see [8.2.x Notes](#) on page 7.

Release	Google Chrome™	Firefox Quantum®	Microsoft Edge™ WebFOCUS only	Internet Explorer®
Release 8205.20	Version 76	Version 68	Version 44	Version 11  Compatibility mode is not supported.
Release 8205.19	Version 75			
Release 8205.17 and 8205.18				
Release 8205.14, 8205.15, and 8205.16	Version 74	Version 66	Version 42	
Release 8205.13				
Release 8205.11 and 8205.12	Version 73			
Release 8205.08, 8205.09, and 8205.10		Version 65		
Releases 8205.04, 8205.05, 8205.06, and 8205.07				
Releases 8205.01, 8205.02, and 8205.03	Version 70	Version 63	Version 41	
Release 8205	Version 69	Version 62		

## 8.2.x Notes

- ☐ Microsoft Edge is not supported with App Studio.
- ☐ Simple HTML WebFOCUS reports can be viewed on any browser.
- ☐ Chart/Graph request notes:
  - ☐ *Browser-generated graphs* refer to graphs that are rendered inside the browser using HTML5 (and JavaScript). Browser-generated graphs are utilized in both standard HTML5 output ("FORMAT JSCHART"), and in Information Builders Active Technologies ("FORMAT AHTML").

- ☐ *Server-generated graphs* refer to traditional Information Builders graph requests that are generated on the Reporting Server and then embedded as a bitmap or vector image in a document or webpage. This includes the following output formats:
  - ☐ Bitmap: PNG, GIF, JPG
  - ☐ Vector: PDF (but not active PDF), SVG
- ☐ Support for presenting images and graphs in HTML, DHTML, and DHTML compound reports is provided using an image embedding facility based on the client browser. Output generated by Internet Explorer browsers or in scenarios where the browser is unknown (such as when distributed by ReportCaster) supports image inclusion through the creation of a web archive file (.mht). For all other browsers, images are base64 encoded within the generated .htm file.
- ☐ Drill-down links do not work when using an embedded PDF viewer available in some browser versions. Refer to the browser's configuration information on how to change the Application Options settings for the relevant content types so that the browser will automatically use Adobe Reader.
- ☐ Adobe Reader support:
  - ☐ Acrobat Reader DC is certified
  - ☐ Adobe XI is supported
  - ☐ Adobe X is supported
- ☐ If you are using Internet Explorer® 11 on a Windows® 2012 R2 OS and you attempt to run an object (such as a report or chart in InfoAssist), Internet Explorer 11 opens it in a new window instead of targeting the object to a specific frame. For example, in InfoAssist, the New Window Runtime opens a new browser window that shows the running image, which then replaces that page with the output. Since Internet Explorer 11 does not allow the replacement of that window, it opens a new window instead.

This browser limitation can be remedied by an administrator. For more information, see <https://social.msdn.microsoft.com/Forums/ie/en-US/a5c294e2-e407-491d-ba6a-b7f7edbcabaf/ie11-cant-post-form-data-to-specific-frame-or-window-dialog-opened-via-windowopen?forum=iewebdevelopment>
- ☐ In order to use Microsoft Edge as the output viewer for App Studio, the version of MicrosoftWebDriver.exe that it uses must correspond to the version of Edge that you have installed. Since Edge updates along with Windows 10, the version of Edge matches the Windows 10 OS build number.



App Studio 8205 includes the MicrosoftWebDriver.exe file for Release 16299 upon installation. For information about finding the OS build number and download links for MicrosoftWebDriver.exe, visit <https://developer.microsoft.com/en-us/microsoft-edge/tools/webdriver/>. Also see Microsoft Issue #19201233 [Webdriver won't launch after update](#) reporting that the WebDriver is not working.

If you have a different version of Windows 10 and Microsoft Edge, download the .exe file from the WebDriver site and save it to your App Studio bin directory (for example, `drive:\ibi\Appstudio82\bin`).

For information regarding earlier releases, see the [Technical Support](#) page.

## Mobile Browser Information

If you are planning to use WebFOCUS products on mobile devices, please note the following regarding mobile browser support. If you will be using WebFOCUS products on the Windows operating system, see [Web Browsers](#) on page 6.

**Note:** Browsers released after the production date of a WebFOCUS version are subject to certification.

WebFOCUS Developer Tools (for example, WebFOCUS Designer, InfoAssist, Portal Designer, and so on) are not supported on mobile devices.

The following were used in testing WebFOCUS:

Release	iOS	Android	Mobile Faves
Releases 8205.04 and higher	Version 12	Versions 8.0, 7.1	Version 3.2.2, iOS Version 3.2.1, Android
Releases 8205.01, 8205.02, 8205.03	Version 12	Versions 8.0, 7.0, 6.0	Version 3.2.1
Release 8205	Version 11.4		

Usage Considerations:

- ☐ ReportCaster interfaces are supported on tablets.
- ☐ HTML reporting Table of Contents (BYTOC) feature is not supported.
- ☐ Viewing PDF, Excel, and PowerPoint documents may require a 3rd party helper app.

- ❑ To open In-Document Analytics content, JavaScript needs to be enabled in your web browser. On mobile devices, please use the Mobile Faves app. If not installed, download it from the App Store for iOS devices or from the Google Play Store for Android devices.

For detailed information on known issues and documentation updates, see the *WebFOCUS Release Notes*.

For information regarding earlier releases, see the *Technical Support* page.

Accessibility Compliance

For information on the Information Builders software products to which Section 508 accessibility standards are applicable, see the following:

- ❑ *Technical Memo 4505*: WebFOCUS HTML Report Accessibility Support
  - ❑ *Technical Memo 4704*: WebFOCUS PDF Report Accessibility Support
- Keyboard navigation is supported with Jaws on a Windows® operating system. For Jaws browser requirement information, see the *Freedom Scientific* website.
- ❑ Release 8205 supports Jaws Version 2019, 2018, and 18.
  - ❑ Internet Explorer browser Version IE 11.
  - ❑ Edge browser is supported with Jaws 2019, 2018, and 18 when Edge support is enabled in Jaws. See the release information in *Web Browsers* for the version certified.
  - ❑ Chrome and Firefox browses are supported with HTML and PDF accessible reports. See the release information in *Web Browsers* for the versions certified.

WebFOCUS Client Supported Operating Systems

The following table describes the WebFOCUS client supported operating systems.

Vendor (Processor /Architecture)	Operating System Version
Microsoft Windows 64-bit	Windows Server 2016, 2012 R2, 2012
	Windows Server 2008 R2 Service Pack 1
	Windows 10, 8.1, and 7 (limited to development environments only)

<b>Vendor (Processor /Architecture)</b>	<b>Operating System Version</b>
IBM i	V7R1
IBM (pSeries 64)	AIX 7.2 and AIX 7.1
IBM (zSeries)	Enterprise Linux Kernel-3.0.101-glibc-2.11 and up
Oracle (Sparc 64-bit)	Oracle Solaris 11
	Oracle Solaris 10
Oracle (x86)	Oracle Solaris 11
	Oracle Solaris 10
Red Hat (x86_64)	Enterprise Linux 6.1 / Kernel 2.6.32 -glibc-2.6 and up
	Enterprise Linux Kernel-3.10.0-glibc-2.17 and up
Red Hat (IBM Power Systems)	Enterprise Linux 6.1 / Kernel 2.6.32 -glibc-2.6 and up
Hewlett Packard (Itanium IA64)	HP-UX 11i (11.31)

For information regarding earlier releases, see the [Technical Support](#) page.

## WebFOCUS Support Statement for Java Platform, Standard Edition (Java SE)

This topic contains information regarding WebFOCUS release support for the different Java SE versions that WebFOCUS and ReportCaster web applications are deployed on. It is also important to verify the Java version requirements of the web application server version before installing or upgrading Java software.

The [WebFOCUS Application Server Minimum JVM Version Requirement](#) on page 12 topic notes the status of WebFOCUS certification of Oracle and OpenJDK Java SE releases. However, please note:

- ❑ Maintenance updates of Java SE within the same version level are supported.

- ❑ Using earlier versions of WebFOCUS with later JDK versions is supported. However, the solution to some problems might require an upgrade to a later WebFOCUS or JDK service pack.
- ❑ Support for later Java SE major releases requires certification and is not supported unless specified in the following chart.
- ❑ In the [WebFOCUS Application Server Minimum JVM Version Requirement](#) on page 12 topic, when reference is made to *certified*, it means that the specified release(s) of Java have been tested within the specified WebFOCUS Release QA (Quality Assurance) certification process.

Please report any problems you experience with a certified or supported version of Java to Customer Support Services for evaluation.

For information regarding earlier releases, see the [Technical Support](#) page.

### WebFOCUS Application Server Minimum JVM Version Requirement

As of WebFOCUS Release 8205, the minimum JVM version requirement for the application server that WebFOCUS and ReportCaster web applications are deployed on is JVM Version 8. For additional information, see [WebFOCUS 8.2 Java, Servlet, and Install Requirements](#).

Java SE Release	Certification Status
8u212	<a href="#">Certified</a> with WebFOCUS Release 8205.15 and higher.
8u202	<a href="#">Certified</a> with WebFOCUS Releases 8205 through 8205.14.

For information regarding earlier releases, see the [Technical Support](#) page.

### Supported RDBMS and Drivers

Supported relational databases for the WebFOCUS repository:

Vendor (RDBMS)	Version	JDBC Driver
Apache Software Foundation (Derby)	10.9.1.0	derbyclient.jar

<b>Vendor (RDBMS)</b>	<b>Version</b>	<b>JDBC Driver</b>
Microsoft® (MS SQL Server®)	2017	sqljdbc42.jar
	2016	sqljdbc41.jar
		sqljdbc4.jar
	2014	sqljdbc4.jar
	2012	sqljdbc4.jar
	2008	sqljdbc4.jar
IBM® (Db2)	11	db2jcc4.jar
	10.5	db2jcc4.jar
	9.7 FP4	db2jcc4.jar
	9.5 FP9	db2jcc4.jar
Oracle® (Database)	12c	ojdbc7.jar
		ojdbc6.jar
	11gR2	ojdbc6.jar
	11g	ojdbc6.jar
	10.2	ojdbc6.jar
Oracle® (MySQL)	5.7.9	mysql-connector-java-5.1.18-bin.jar
	5.5.x	mysql-connector-java-5.1.18-bin.jar
	5.1.x	mysql-connector-java-5.1.18-bin.jar
Postgresql	9.6.x	postgresql-9.2-1002.jdbc4.jar
	9.5.x	

For information regarding earlier releases, see the [Technical Support](#) page.

## Supported Web and App Servers

Supported Web and Applications Servers:

Vendor	Version
Web Server & Application Server	
Apache Software Foundation (Apache Tomcat®)	8.5.x (latest version)
Apache Software Foundation (Apache HTTP)	2.4
	2.2
IBM® HTTP Server	8.5.5
IBM® WebSphere®	8.5.5.9 and higher
Microsoft® (IIS)	7.0 and higher
Oracle® WebLogic	12c (12.2.2.1, 12.1.3.0.0)
Red Hat® (JBoss)	Enterprise Application Platform 6.3

For information regarding earlier releases, see the [Technical Support](#) page.

## WebFOCUS SOAP Web Services Minimum Axis Version Requirement

As of WebFOCUS Release 8.2, the minimum Axis version requirement for WebFOCUS SOAP Web Services is Axis 2.

## Localization (NLV) and NLS Support

Information Builders provides National Language Support and Localized Version support for WebFOCUS and App Studio in select languages. Requests for additional languages may be submitted by contacting Customer Support Services and opening a New Feature Request.

For information regarding earlier releases, see the [Technical Support](#) page.

## National Language Support (NLS)

National Language Support (NLS) involves reading and interpreting data stored in code pages that represent the character sets of various international languages. Information Builders' proprietary NLS application programming interface (API) code-page architecture transcodes data between application client and server components and manages all sorting, case conversion, and formatting for dates, currency, and numbers.

## Localized Version Support (NLV)

A localized version is a software product in which the user interface (for example, menus and utilities) appears in a particular language. Information Builders localized versions are positional. Each button or menu choice is always in the same relative position in the product, and only the text of the labels changes. Therefore, it is easy for anyone who is familiar with an Information Builders' product in one language to support that product in another language.

Localized versions have complete National Language Support (NLS) capability. You can access data for any supported language, with all national characters processed, displayed, and printed correctly.

## WebFOCUS and Reporting Server

WebFOCUS Reporting Server Release supports the following code pages for data processing:

### ASCII Platforms

137 - U.S. English/Western Europe (Latin 1)	923 - Latin 9 (ISO 8859-15)
437 - U.S. English	942 - Japanese (shift-JIS)
813 - Greek (ISO 8859-7)	946 - Simplified Chinese
850 - Western Europe	949 - Korean
852 - Central Europe	1089 - Arabic (ISO 8859-6)
857 - Turkish	1250 - Central Europe (Latin 2)
860 - Portuguese	1251 - Cyrillic (Windows)
862 - Hebrew	1252 - Windows (Latin 1)
863 - French Canadian	1253 - Greek (Windows)

865 - Nordic	1254 - Turkish (Windows)
866 - Cyrillic II	1255 - Hebrew (Windows)
869 - Greek	1256 - Arabic (windows)
912 - Central Europe (ISO 8859-2)	1257 - Baltic (Windows)
915 - Cyrillic (ISO 8859-5)	10942 - Japanese (EUC)
916 - Hebrew (ISO 8859-8)	10948 - Traditional Chinese
920 - Turkish (ISO 8859-9)	65001 - Unicode (UTF-8)
921 - Baltic (ISO 8859-13)	

#### **EBCDIC Platforms (IBM z/OS and IBM i)**

37 - IBM EBCDIC United States	500 - IBM EBCDIC International European
273 - IBM EBCDIC Germany F.R./ Austria	870 - IBM EBCDIC Multilingual (Latin 2, Eastern Europe)
277 - IBM EBCDIC Denmark, Norway	871 - IBM EBCDIC Iceland
278 - IBM EBCDIC Finland, Sweden	875 - IBM EBCDIC Greece
280 - IBM EBCDIC Italy	1025 - IBM EBCDIC Cyrillic, Multilingual
284 - IBM EBCDIC Spain/Latin America	1026 - IBM EBCDIC Turkish
285 - IBM EBCDIC United Kingdom	1047 - IBM EBCDIC Open Systems (Latin 1)
297 - IBM EBCDIC France	1112 - IBM EBCDIC Baltic Multilanguage
424 - IBM EBCDIC Israel (Hebrew)	65002 - Unicode (UTF-EBCDIC)



## Language

The LANGUAGE parameter specifies the National Language Support (NLS) environment. It sets the language of server error messages and can also be used to set the language of report titles if the Master File contains alternate language TITLE attributes. For more information, see the *Describing Data With WebFOCUS Language* technical content.

The WebFOCUS Reporting Server Console, DataMigrator, and the Data Management console support the following languages.

(\* Localized versions)

- ☐ AMENGLISH
- ☐ AUENGLISH\*
- ☐ ARABIC
- ☐ B-PORTUGUESE
- ☐ CAENGLISH\*
- ☐ CROATIAN
- ☐ CZECH
- ☐ DANISH
- ☐ DUTCH
- ☐ ENGLISH
- ☐ ESTONIAN
- ☐ FINNISH
- ☐ FRENCH\*
- ☐ GERMAN\*
- ☐ GREEK
- ☐ HEBREW
- ☐ HUNGARIAN
- ☐ ITALIAN
- ☐ JAPANESE\*

- ☐ KOREAN
- ☐ LATVIAN
- ☐ LITHUANIAN
- ☐ NORWEGIAN
- ☐ POLISH
- ☐ PORTUGUESE
- ☐ ROMANIAN
- ☐ RUSSIAN
- ☐ S-CHINESE\*
- ☐ SLOVAK
- ☐ SPANISH\*
- ☐ SWEDISH
- ☐ T-CHINESE\*
- ☐ THAI
- ☐ TURKISH
- ☐ UKENGLISH

### **WebFOCUS Client and ReportCaster**

The following localized versions are available for the WebFOCUS Client and ReportCaster.

Translation and certification of the following languages is done by Information Builders:

#### **GROUP 1 (Full Translation)**

- ☐ English (Australian, Canadian, United Kingdom, and United States)
- ☐ French (Canadian and Standard)
- ☐ German
- ☐ Spanish

**GROUP 2 (Partial Translation)**

Limited areas have been translated and tested by Information Builders Agents and Partners. Strings that translation has not been provided for will display in English.

- ☐ Brazilian Portuguese
- ☐ Chinese (Simplified)
- ☐ Italian
- ☐ Japanese

**GROUP 3 (Evaluating)**

Limited areas have been translated and tested by Information Builders Agents and Partners for demonstration purposes. Strings that translation has not been provided for will display in English. Contact Information Builders for instructions to enable.

- ☐ Korean
- ☐ Russian

**App Studio**

The following localized versions are available for App Studio.

**GROUP 1 (Full Translation)**

- ☐ English
- ☐ French

**GROUP 2 (Partial Translation)**

Limited areas have been translated and tested by Information Builders Agents and Partners. Strings that translation has not been provided for will display in English.

- ☐ Brazilian Portuguese

**WebFOCUS Open Portal Services - Supported Portals**

WebFOCUS Open Portal Services supports SharePoint 2013 on-premises, SharePoint 2016 on-premises and Office 365 Cloud, Azure Cloud, and any 100% JSR 268 compliant portal.

## WebFOCUS and App Studio Release Availability

Use the release information below, as well as the About WebFOCUS release information that is installed with WebFOCUS or App Studio software, to confirm the Feature/Service Pack, Package Name and Gen level for your products. The information below also contains the Reporting Server release and gen information that is certified with this version of the WebFOCUS Client and App Studio.

WebFOCUS agile development targets incremental releases, approximately every two to four weeks, and include both maintenance enhancements and new features. Each incremental release is a single, cumulative package that can be applied as a full installation or as a service pack when upgrading.

Each release goes through our standard quality assurance validation process and targeted product area testing related to the fixes completed. Periodically, Information Builders replaces a release on the download site at My Downloads with the current certified release. These releases are designated as Prod.

Additional gens of these releases are made available, on-demand only, when needed. These Gens are Information Builders' mechanism for providing rapid turnaround fixes for customer-reported problems. They are production quality Gens, but they are only certified on customer-reported platforms. They must be requested for a customer by opening a case via InfoResponse Online. Alternatively, if you are a North American customer, you may call 1-800-736-6130 from 8:00 to 20:00 Eastern Time, Monday to Friday. If you are an international customer, contact your local office.

Information Builders publishes a list of fixes that are included in each incremental release. This information is in the table below, and available from the [WebFOCUS KnowledgeBase](#). It is recommended that customers review this information in detail in order to determine the product areas impacted and the potential scope of testing that would be prudent to implement.

<b>Release Fixes</b>	<b>WebFOCUS Client/ ReportCaster</b>	<b>App Studio</b>	<b>Reporting Server Fixes</b>
8205.20	wf080119a Gen 117	as080119a	8205 Gen 1547
8205.19	wf072719a Gen 116	as072719a	8205 Gen 1546

<b>Release Fixes</b>	<b>WebFOCUS Client/ ReportCaster</b>	<b>App Studio</b>	<b>Reporting Server Fixes</b>
8205.18	wf071519a Gen 113	as071519a	8205 Gen 1545
8205.17	wf062619a Gen 110	as070119a	8205 Gen 1544
8205.16	wf061419a Gen 108	as061419a	8205 Gen 1543
8205.15	wf053019a Gen 104	as053019a	8205 Gen 1542
8205.14	wf052119a Gen 101	as052119a	8205 Gen 1541
8205.13	wf050819a Gen 93	as050819a	8205 Gen 1540
8205.12	wf042319a Gen 88	as042319a	8205 Gen 1539
8205.11	wf040819a Gen 84	as040819a	8205 Gen 1538
8205.10	wf032919a Gen 78	as032919a	8205 Gen 1537
8205.09	wf031219a Gen 71	as031219a	8205 Gen 1536
8205.08	wf022319a Gen 64	as022319a	8205 Gen 1535
8205.07	wf012919a Gen 44	as012919a	8205 Gen 1526

<b>Release Fixes</b>	<b>WebFOCUS Client/ ReportCaster</b>	<b>App Studio</b>	<b>Reporting Server Fixes</b>
8205.06	wf011619a Gen 33	as011619a	8205 Gen 1525
8205.05	wf122718a Gen 27	as122718a	8205 Gen 1524
8205.04	wf121918a Gen 25	as121918a	8205 Gen 1523
8205.03	wf120518a Gen 21	as120518a	8205 Gen 1522
8205.02	wf111518a Gen 19	as111618b	8205 Gen 1521
8205.01	wf110918a Gen 18	as110918a	8205 Gen 1520
8205	wf101218b Gen 13	as101218b	8205 Gen 1518

For information regarding earlier releases, see the [Technical Support](#) page.

## WebFOCUS Reporting and Microsoft Office Support

This topic provides details on the support of WebFOCUS reporting formats that generate output in Microsoft® Office products. It also provides usage considerations for hyperlinks that execute dynamic drill-down requests to procedures protected by WebFOCUS security.

## WebFOCUS Reporting Formats and Microsoft Product Association

The following table shows the WebFOCUS formats that create Microsoft Excel and PowerPoint reports, the Microsoft Office application associations, and the Windows operating system version availability.

WebFOCUS Formats	Microsoft Office Products	Windows Operating System
XLSX	Microsoft Office 365, Microsoft Office 2016	Windows 10
	Microsoft Office 2016, 2013, 2010, 2007	Windows 8
	Microsoft Excel Viewer 2007	Windows 7
PPTX	Microsoft Office 365, Microsoft Office 2016	Windows 10
	Microsoft Office 2016, 2013, 2010, 2007	Windows 8
	Microsoft PowerPoint Viewer 2010	Windows 7
EXL2K (Functionally stabilized)	Microsoft Office 2003, 2000	Windows XP Windows 2000
PPT (Functionally stabilized)	Microsoft Office 2003, 2000	Windows XP Windows 2000

For additional information on Microsoft Office releases compatible with Windows operating systems, see [Get Windows 10 App](#), which has a customized compatibility report for each PC, and provides a unified compatibility view of a PC, its onboard devices, and applications.

### WebFOCUS EXL2K and PPT Formats and Microsoft Office Suite Support

Due to file type and content security policy changes implemented by Microsoft, the WebFOCUS EXL2K and PPT formats are not supported with Microsoft Office 2013 and higher. The WebFOCUS XLSX and PPTX formats fully support the Microsoft Excel® XLSX and Microsoft PowerPoint® PPTX file types and content security policies of Office 2013 and higher.

## Microsoft Office 2003 Support

See [Get Windows 10](#), which has a customized compatibility report for each PC, and provides a unified compatibility view of a PC, its onboard devices, and applications. In WebFOCUS products, although you will still be able to start and work in Microsoft Office 2003 applications, Microsoft recommends that you upgrade to a later version of Office in order to continue to receive support and updates. If your organization uses Office 2003 with the Windows® XP operating system, see [Support for Windows XP ended](#) for information on the end of support for Microsoft Office 2003 and Windows XP SP3.

For information on opening, editing, and saving documents, workbooks, and presentations that were created in the later versions of Microsoft Excel and PowerPoint, see [Microsoft Office Compatibility Pack for Word, Excel, and PowerPoint File Formats](#).

## WebFOCUS EXL2K and PPT Formats and Microsoft Office Viewer Products Support

Microsoft Excel Viewer and PowerPoint Viewer are read-only products. They permit only the display and printing of Microsoft Excel and PowerPoint data. The WebFOCUS EXL2K and PPT reports are not supported in any release of the Microsoft Excel Viewer and the Microsoft PowerPoint Viewer. The WebFOCUS XLSX and PPTX formatted reports are supported and can be viewed with the Microsoft Excel Viewer and Microsoft PowerPoint Viewer, respectively.

Microsoft has released statements that older releases of the Microsoft Excel and PowerPoint Viewer are no longer supported. For information on the supported versions of Microsoft Office Viewer products, see [Supported versions of the Office viewers](#). The Microsoft Office Viewer is available from the [Microsoft Download Center](#).

## Microsoft Office 365 Support

Microsoft Office 365™ offers the local installation of Microsoft Excel and PowerPoint 2013. It works with the Office 2010 release and provides limited functionality with Office 2007. Microsoft Office 365 also permits uploading Microsoft Excel and PowerPoint files to the cloud, where they can be accessed on most devices using Office Online. For information on the Microsoft Office 365 plans and features, see [Office 365 for business FAQ](#).

You can use Microsoft Office 365 to access WebFOCUS XLSX and PPTX reports. First, create the XLSX and PPTX reports locally as HOLD files, or display the reports on the screen using the PCHOLD command, and then save the reports to a local directory. The saved files can be uploaded and stored in OneDrive® for Business. Once uploaded to the cloud, the files can be accessed using Office Online.

For information on saving WebFOCUS reports, see the *Creating Reports with WebFOCUS Language* manual listed in *Recommended Reading*.



For information on the differences in features available in Excel Online and PowerPoint Online, and in Microsoft Office 2013, see [Office Online Service Description](#).

For more information on working with Office Online and OneDrive for Business, see [Using Office Online in OneDrive](#).

## Usage Consideration When Using Hyperlinks to Run WebFOCUS Reports

Selecting a hyperlink in a WebFOCUS report, to execute a drill-down request to run a procedure on a secured WebFOCUS web environment, requires the security context or any session-related cookies to be inherited. Microsoft Office products do not natively inherit the security context or any session-related cookies created by a web-based application.

The following options are available to configure your web environment so that hyperlinks in WebFOCUS reports will be functional within Microsoft Office products.

- ☐ Configure WebFOCUS authentication to allow anonymous access. For more information, see the *WebFOCUS Security and Administration* manual.
- ☐ Use SSO with IIS/Tomcat Integrated Windows Authentication. Renegotiation occurs automatically and the Excel and PowerPoint reports display correctly.
- ☐ As of WebFOCUS Release 8, the Remember Me feature can be enabled on the Sign-in page. If the end user uses the Remember Me feature, a persistent cookie is used. For more information on how Microsoft Office products handle session-related information, see [Error message when clicking hyperlink in Office: "Cannot locate the Internet server or proxy server"](#).

## WebFOCUS DOC Format

The WebFOCUS standard for styled and printable documents is the Acrobat® PDF format. The WebFOCUS PDF format creates Acrobat PDF documents. The WebFOCUS DOC format produces a character-based file, not a Microsoft Word document.

## Recommended Reading

[WebFOCUS EXL07/XLSX Format Supported Features Release Roadmap](#)

[WebFOCUS PPTX Format Supported Features Release Roadmap](#)

[Microsoft Windows Support Statement for WebFOCUS](#)

[Saving Report Output in Excel XLSX Format](#) topic in the *Creating Reports for WebFOCUS Language* manual, available from the [WebFOCUS 8 Technical Library](#).

*Saving and Reusing Your Report Output* topic in the *Creating Reports for WebFOCUS Language* manual, available from the [WebFOCUS 8 Technical Library](#).

### Additional Resources

The following Technical Support pages contain additional resources that you can reference, but are not specific to your release.

- ❑ [Advisories](#)
- ❑ [Compatibility Notices](#)
- ❑ [Release Availability](#)
- ❑ [Support Notices](#)
- ❑ [Supported Operating Systems for the WebFOCUS Client](#)
- ❑ [WebFOCUS 8.2 Java, Servlet, and Install Requirements](#)
- ❑ [WebFOCUS 8.2 WebFOCUS and App Studio Consolidated Features](#)
- ❑ [WebFOCUS EXL07/XLSX Format Supported Features Release Roadmap](#)
- ❑ [WebFOCUS Release 8 Chart Formats Statement](#)
- ❑ [WebFOCUS Server Support Statement for JVM](#)



# Chapter 2

## WebFOCUS 8205 Release Considerations

---

These topics provide release considerations and product changes for WebFOCUS Release 8205 with Reporting Server 7709.

Before reading this documentation, Information Builders recommends reviewing the release considerations for all intermediate releases, as well as the *WebFOCUS Release Notes*, which includes known issues and product limitations. These documents, which are periodically updated as needed, are located in the Technical Library:

<https://techsupport.informationbuilders.com/public/tc-library.html>

### In this chapter:

- ☐ [Active Technologies](#)
  - ☐ [App Studio](#)
  - ☐ [Autoprompt](#)
  - ☐ [Charts and Graphs](#)
  - ☐ [InfoAssist](#)
  - ☐ [National Language Support](#)
  - ☐ [WebFOCUS Infrastructure and Security](#)
  - ☐ [WebFOCUS Language](#)
- 

### Active Technologies

The following are release considerations and product changes for Active Technologies.

- ☐ You can now use the Save Changes column menu option when working with In-Document Analytics (Active Technologies) reports at run time using non-Internet Explorer browsers.
- ☐ When using the In-Document Analytics Export to XML (Excel) option in AHTML format with CACHE OFF at run time, the output file is sent to the Downloads folder, regardless of the browser used.
- ☐ As of Release 8205, the Flex Software Development Kit (SDK) is no longer shipped with the 7709/8205 WebFOCUS Reporting Server.

If you use the FLEX or APDF output formats, you must download your own version of the Flex SDK from *flex.apache.org* and include *FlexSDK\_download\_location/lib/flex-compiler-oem.jar* file in your CLASSPATH setting in *edaenv.cfg*. In addition, you must copy the *arFlexLib.swc* from *\$EDAHOME/etc* to the *FlexSDK\_download\_location/frameworks/libs* directory prior to server startup. For more information, contact your system administrator.

## App Studio

The following is a release consideration and product change for App Studio.

- ❑ In Release 8205, the link in the WebFOCUS Administration menu from App Studio to the WebFOCUS Home Page has been renamed from BI Portal to WebFOCUS Home Page.
- ❑ In Release 8205, the following changes have been made to the Home tab:
  - ❑ The Data button, formerly in the *Content* group, has been removed. It has been replaced with the *Data & Metadata* group, which includes the following commands:
    - ❑ **Create.** Creates synonyms for tables in a data source. Equivalent to clicking *Synonym* from the Data menu in past releases.
    - ❑ **Design.** Creates a synonym using the Metadata canvas. Equivalent to clicking *Create New Synonym* from the Data Source Definition Wizard menu in past releases.
    - ❑ **Open.** Opens a synonym in the Metadata canvas. Equivalent to clicking *Open Existing* from the Data Source Definition Wizard menu in past releases.
    - ❑ **Upload Data.** Opens the Upload Wizard. Previously accessible by right-clicking a folder in the Environments Tree panel.
    - ❑ **More.** Contains the Passwords (equivalent to clicking *Data Source Password* from the Data menu in past releases), Rebuild a Connection (equivalent to clicking *Rebuild Data Source* from the Data menu in past releases), and Command Console commands.
  - ❑ The Command Console command has been moved from the *Utilities* group. It is now available in the *Data & Metadata* group, under the More menu.
  - ❑ The *Utilities* group has been removed and replaced with the *Configure* group, which contains the Connect (equivalent to clicking *Manage Adapters* from the Data menu in past releases) and Environments commands.
  - ❑ The View group now uses panel buttons instead of check boxes.

- ❑ The *Window* group, including the *Windows* command, has been removed. As an alternative, navigate between applications using the tabs available above the canvas, or use the drop-down arrow to the right of the tabs.
  - ❑ When migrating Maintain forms from legacy Maintain to Maintain Data in Release 8205, the ActiveX grid is no longer available, and is replaced with the JS grid. If any JavaScript functions were used to interact with the ActiveX grid, they must be updated to their JS grid equivalents. For a list of available functions, see the *Creating Maintain Data Applications* chapter in the *WebFOCUS App Studio User's Manual* technical content.
  - ❑ In Release 8205, when you copy and paste or move an HTML page from one domain folder to another, App Studio recognizes that the location has changed. When you open the HTML page, an alert message appears, allowing you to update the file paths of content referenced in the HTML page, or continue using the existing file paths. If you do not update the file paths, referenced content may not work as expected.
  - ❑ In Release 8205, the run-time appearance of the double list control has been updated. It now includes double arrow buttons that perform the following functions:
    - ❑ **Double right arrow.** Adds all values from the available list to the selected list.
    - ❑ **Double left arrow.** Removes all values from the selected list to the available list.
    - ❑ **Double up arrow.** Moves the selected value or values to the top of the selected list.
    - ❑ **Double down arrow.** Moves the selected value or values to the bottom of the selected list.
- The available list in the double list control is now sorted. When you remove an item from the selected list, it returns to its original position in the available list.
- ❑ In Release 8205, dynamically populated controls in an HTML page do not display an All option if there is only one available value. You can display the All option for dynamically populated controls with multiple available values by selecting the control object, opening the *Settings* panel, and selecting the *Add "All" option* check box.
  - ❑ In Release 8205, the calendar control in an HTML page has been changed from an input element to a div element with an input element within it. JavaScript functions, such as `getElementById`, that handle the calendar as an input element are affected as a result. As an alternative, use an `IbComposer` API function.

- ❑ In Release 8205, the content creation options in the New submenu in the Environments Tree panel shortcut menu have been organized into the following categorized submenus:
  - ❑ **Reporting.** Expands a submenu containing the following options.
    - ❑ **Report.** Creates a new report.
    - ❑ **SQL Report.** Creates a new SQL report.
  - ❑ **Designer.** The Designer submenu is only available when you right-click a file or folder in the Domains area. The Designer submenu contains the following options.
    - ❑ **Workbook.** Creates a new workbook using WebFOCUS Designer.
    - ❑ **Chart.** Creates a new chart using WebFOCUS Designer.
    - ❑ **Page.** Creates a new Designer page.
  - ❑ **InfoAssist.** Expands a submenu containing the following options.
    - ❑ **Chart.** Creates a new chart using the Chart canvas.
    - ❑ **SQL Chart.** Creates a new SQL chart.
    - ❑ **Visualization.** Creates a new visualization. This option is only available from within the Domains area.
    - ❑ **Alert.** Creates a new alert. This option is only available from within the Domains area.
  - ❑ **Data & Metadata.** The Data & Metadata submenu is only available when you right-click a file or folder in the Data Servers area. The Data & Metadata submenu contains the following options.
    - ❑ **Synonym.** Creates a new Master File after you have selected a configured adapter, or configure a new adapter.
    - ❑ **Synonym via Metadata Canvas.** Creates a new Master File in the Metadata canvas.
    - ❑ **Define Function Library.** Creates a user-defined function library. Any user-defined functions created in this library are available for use in any content created within the same folder as the library.
    - ❑ **Upload Data.** Connects to the Upload Desktop File utility in the Reporting Server Console. Using this utility, you can upload new data to an application.

- ❑ **Schedule.** The Schedule submenu is only available when you right-click a file or folder in the Domains area. The Schedule submenu contains the following options.
  - ❑ **Schedule.** Creates a new schedule.
  - ❑ **Distribution List.** Creates a new distribution list.
  - ❑ **Library Access List.** Creates a new library access list.
- ❑ **Text Editor.** Expands a submenu containing the following options.
  - ❑ **JavaScript File.** Creates a new JavaScript file from which you can create original JavaScript. The JavaScript File option is only available from within the Domains area.
  - ❑ **Cascading Style Sheet.** Creates a new cascading style sheet. The Cascading Style Sheet option is only available from within the Domains area.
  - ❑ **WebFOCUS StyleSheet.** Creates a new WebFOCUS StyleSheet.
  - ❑ **Text Document.** Creates a new text document.
- ❑ **Other.** The Other submenu is only available when you right-click a file or folder in the Domains area. The Other submenu contains the following options.
  - ❑ **Reporting Object.** Creates a new reporting object.
  - ❑ **Portal Page.** Creates a new portal page, in a tab within App Studio, using the Page Designer.
  - ❑ **Collaborative Portal.** Creates a new portal, in a tab within App Studio, using the Portal Designer.
  - ❑ **URL.** Creates a new URL.
  - ❑ **Blog.** Opens the Blog Viewer, in a tab within App Studio, where you can manage and read your blog posts.
- ❑ In Release 8205, the Do not show on user's list property, in the File/Folder Properties panel for a file or folder, has been renamed to Shown to other users. Setting this property to Yes makes the selected item visible to other users, and replaces the No option for the Do not show on user's list property. Setting Shown to other users to No hides the selected item from other users, replacing the Yes option for Do not show on user's list. This setting is updated automatically for existing files and folders upon upgrading to maintain previous behavior.

- ❑ In Release 8205, Active Technologies has been rebranded to In-Document Analytics. The following areas are affected:
  - ❑ The active report (AHTML) and active PDF (APDF) output formats for reports have been renamed to HTML Analytic Document and PDF Analytic Document, respectively. The AHTML and APDF WebFOCUS language format names remain unchanged.
  - ❑ The active report Options tab in the Report canvas has been renamed to the Analytic Document Options tab. On the Analytic Document Options tab, the Active Cache group has been renamed to the Cache group.
  - ❑ The active report and active PDF output formats for documents in the HTML/Document Wizard and Properties panel have been renamed to Analytic Document (HTML) and Analytic Document (PDF), respectively. The AHTML and APDF WebFOCUS language format names remain unchanged.
  - ❑ In the HTML canvas, on the Utilities tab, the active reports group has been renamed to the Analytic Documents group.
  - ❑ In the HTML canvas, in the Settings panel, the active report data type for controls has been renamed to Analytic Document.
  - ❑ In the HTML canvas, in the Tasks & Animations panel, the active report Target type for a refresh action has been renamed to Analytic Document.

## Autoprompt

The following are release considerations and product changes for Autoprompt:

- ❑ In WebFOCUS Release 8205, the new aptemplates.xml file, which is located in *drive:\ibi\WebFOCUS82\client\wfc\etc\prod*, replaces the APTemplates.xml file, which was located in *drive:\ibi\WebFOCUS82\config* in earlier versions of Release 8.2. The new aptemplates.xml file allows you to add custom autoprompt templates to the list of values in the Default Autoprompt Template (IBI\_DESCRIBE\_TEMPLATE) setting, which is located on the Parameter Prompting Settings page of the Administration Console Configuration Tab.

The upgrade installation for Release 8205 saves the APTemplates.xml file in *drive:\WebFOCUS\82nn\_backup\config*, where *nn* is the number of the release from which you are upgrading. If you maintained a list of custom autoprompt templates in earlier versions, you must transfer that list from the APTemplates.xml file in the backup location *drive:\WebFOCUS\82nn\_backup\config* to the new aptemplates.xml file after you upgrade to Release 8205.



In order to transfer the list:

1. Navigate to *drive:\ibi\WebFOCUS82\client\wfc\etc\*.
2. Open the *\prod* folder, create a copy of the new aptemplates.xml file, and paste it into the *\custom* folder.
3. In the *\custom* folder, open the new aptemplates.xml file in a text editor.
4. Navigate to *drive:\WebFOCUS\82nn\_backup\config\*, where *nn* is the number of the release from which you are upgrading.
5. Open the APTemplates.xml file in a text editor, and copy the <template name> tags that identify the existing custom templates.
6. Paste the <template name> tags for the existing custom templates after the <APTemplates> tag of the new aptemplates.xml file that is located in the *\custom* folder.
7. Save and close the files.
8. Sign in to WebFOCUS as an administrator, and open the Administration Console.
9. In the Administration Console Menu bar, click *Clear Cache*.
10. When you receive a message stating that the individual caches are clear, click *OK*.
11. Test the updated aptemplates.xml file.

For more information, see the *How to Add Customized Autoprompt Templates* procedure and the *How to Test Customized Autoprompt Templates* procedure located in the *Security and Administration* technical content.

- ❑ As of WebFOCUS Release 8.2, parameter-based simple filters are required to have a specified default value or a value entered by the user. If this validation improvement impacts your existing reports that use the Autoprompt facility, contact Customer Support for assistance.

## Charts and Graphs

The following is a release consideration and product change for WebFOCUS charts and graphs.

### X-Axis Title Changes for Matrix Charts

Instead of repeating the group label on the x-axis in every column of a matrix chart, there is now a single instance of the x-axis title appended to the matrix hierarchy column title at the top of the chart.

For example, in prior releases, the x-axis label Product Category appears in every column of the matrix, as shown in the following image.



Starting in the current release, the Product Category label is appended to the Customer Business Region column title, as shown in the following image.

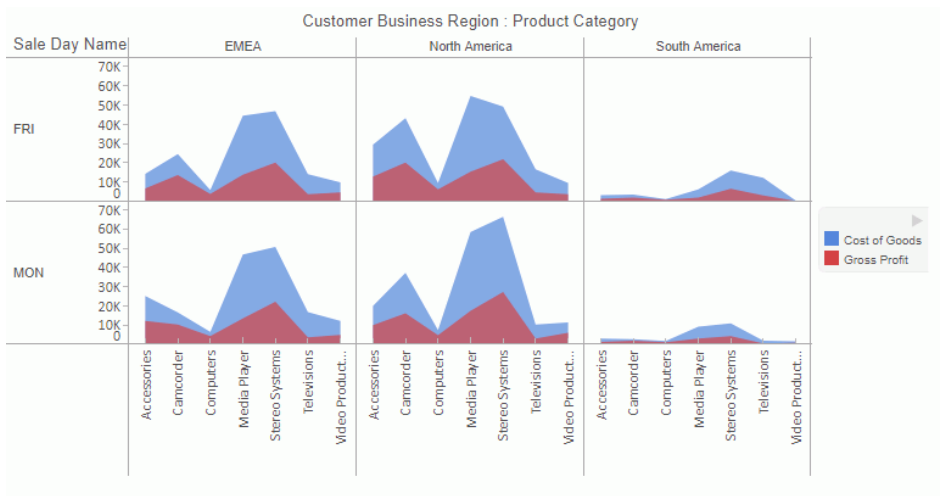

## InfoAssist

The following is a release consideration and product change for InfoAssist.

- ❑ When working in InfoAssist Query mode, if a subquery is present and there is no ACROSS field in the request, the data is only refreshed at run time. It is not refreshed at design time as you edit your content, improving performance.

## National Language Support

The following is an upgrade consideration and product change for National Language Support:

- ❑ As of WebFOCUS Release 8.2 Version 02, the two-character Language Code used by the WebFOCUS Client was expanded to include the full five-character ISO Country Code that accommodates multiple locales for a particular language. For more information about ISO Country Codes, see [https://www.w3schools.com/tags/ref\\_country\\_codes.asp](https://www.w3schools.com/tags/ref_country_codes.asp).

When the <SET>IBIWF\_language(PASS) command is added to the Custom Settings page on the Administration Console Configuration tab, the WebFOCUS Client sends the language code from the current user session along with requests to the Reporting Server.

Applications that evaluate the &IBIWF\_language amper variable require remediation to enable them to evaluate the combined ISO Language Code and Country Code, such as en-GB for English, United Kingdom.

Report requests that display the value assigned to the &IBIWF\_language amper variable, such as those that include it in the heading of a report, are expected to display the full five-character Language Code, such as en-GB.

## WebFOCUS Infrastructure and Security

The following are release considerations and product changes for WebFOCUS security:

- ❑ In WebFOCUS Release 8205, the Anonymous Authentication method is no longer enabled, by default, in any of the Security Zones.
- ❑ In WebFOCUS Release 8205, the mfdistribution.bat and mfdistribution.sh utilities are no longer available for use.

- ❑ In WebFOCUS Release 8205, the `IBI_FOCUS_WARNING_NUMBERS` setting, located on the Other Settings page of the Administration Console Configuration tab, was renamed from *Convert FOCUS Errors to Warnings for Schedules* to *Convert FOCUS Errors to Warnings*, and the FOC warning message numbers 2661, 2662, and 2663 were added to the default values assigned to this setting. As a result, users now receive the *No output was returned* message when the FOC2661, FOC2662, and FOC2663 warning messages are generated, and traces capturing these warning messages are no longer highlighted as errors in the Session Viewer.
- ❑ In WebFOCUS Release 8205, the default log level setting assigned to the `com.ibi.valuevalidation` logger changed from INFO to ERROR, and the default log level setting assigned to the `com.ibi.webapp.security` logger changed from WARN to INFO. These changes reduce the number of entries posted to the websecurity log and the size of websecurity.log files.
- ❑ In WebFOCUS Release 8205, the check box in the Enable Auto Sign-out setting is now selected, by default, assigning a default value of TRUE to that setting. The new default value ensures that the automatic sign-out feature is activated without requiring any additional configuration as soon as the upgrade installation is complete. After upgrading to this version, administrators must clear the Enable Auto Sign-out setting check box if they do not wish to use the automatic sign-out feature. The Enable Auto Sign-out setting is located on the BI Portal page of the Administration Console Configuration tab.
- ❑ In WebFOCUS Release 8205, the Preserve Created, Modified and Last Access Information (`IBI_CM_PRESERVE_SOURCE_INFO`) check box, located on the Change Management settings page of the Application Console Configuration tab, is selected, by default. As a result, the date, time, and user ID values assigned to the Created, Modified, and Accessed fields when an item is added to an export scenario are preserved during the import and assigned to the Created, Modified, and Accessed fields in the Properties panel of those items after the import is complete. Before this change, the date and time of the change management import itself and the ID of the user who ran it were assigned to all three fields for each item imported through the Change Management utility, overriding the original values.

The default selection of this check box is the recommended value for this setting. However, if your organization does not wish to retain the original values assigned to the Created, Modified, and Accessed fields of items imported using the Change Management utility, clear this check box after the installation is complete.

**Note:** In the Properties dialog box that opens from the Legacy Home Page, these values appear in the Created On, Created By, Last Modified On, Last Modified By, Last Accessed On, and Last Accessed By fields.

- ❑ In WebFOCUS Release 8205, collaborative portals, portal pages, and blogs that were created when the Collaborative Portal (IBI\_V4\_PORTAL) setting check box was selected (True) remain visible in their domain folders after this check box is cleared (False). Even though administrators and domain developers are unable to create new items, they can continue to view, run, edit, and delete previously-created collaborative portals, portal pages, or blogs. In earlier versions, previously-created collaborative portals, portal pages, and blogs became invisible when this check box was cleared.
- ❑ In WebFOCUS Release 8205, the Edit SAML Authentication Settings dialog box, which opens from the Authentication page of the Administration Console Security tab, contains many new and relocated fields and check boxes.

These changes enable the SAML Authentication configuration to support identity provider-initiated authentication. In this configuration, the identity provider must initiate single sign-on requests and submits them to WebFOCUS. The identity provider does not accept single sign-on requests initiated by the service provider.

As part of this configuration, it is necessary to prevent the initiation of sign-on requests from WebFOCUS when a session is temporarily suspended or disrupted. Under these conditions, WebFOCUS can return an http 401 or http 403 error message to the identity provider instead of a new single sign-on request, which the identity provider cannot accept.

In order to configure WebFOCUS to support this behavior the new Disable Service Provider (SP) Initialized Single Sign-On check box must be selected. This check box appears on the Advanced tab of the Edit SAML Authentication Settings dialog box.

Other changes in this dialog box are listed in the following paragraphs.

## Service Provider (SP) Metadata Tab

Changes to the Service Provider (SP) Metadata tab are shown in the following image:

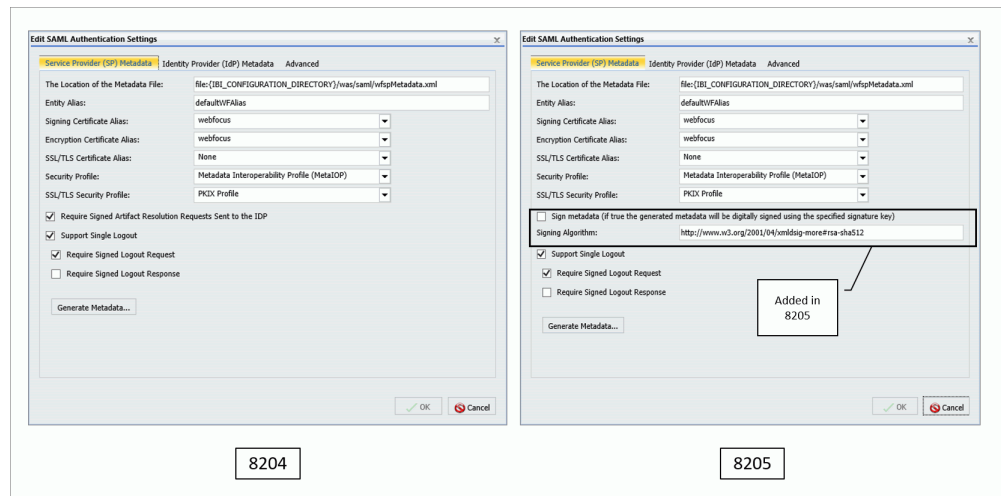

1. Removed the Require Signed Artifact Resolution Requests Sent to the IDP check box from this tab in 8204 and relocated it to the Identity Provider (IdP) Metadata tab in 8205.
2. Added the Sign metadata (If true the generated metadata will be digitally signed using the specified signature key) check box and the Signing Algorithm field, which identifies the URL of the Signing Algorithm selected for the signature key to the 8205 version of this tab.

## Identity Provider (IdP) Metadata Tab

Changes to the Identity Provider (IdP) Metadata tab are shown in the following image:

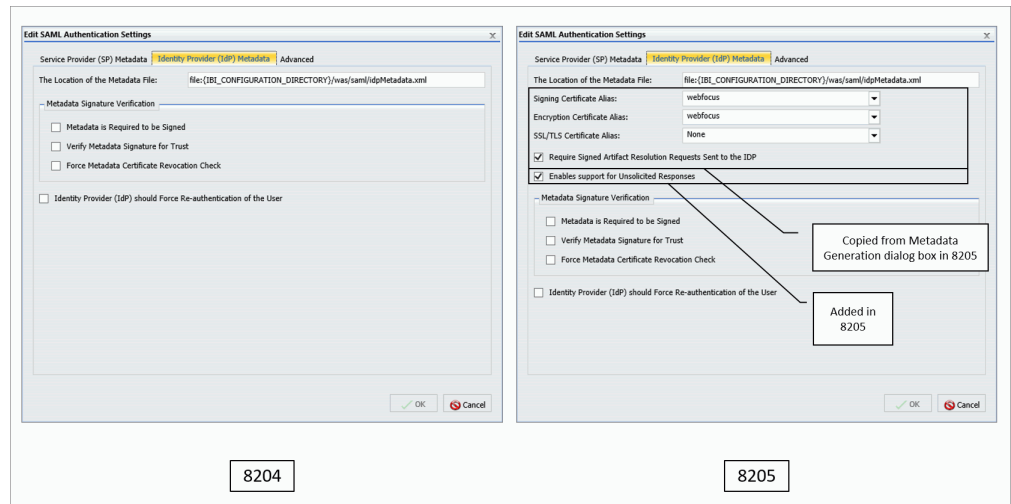

1. Added the Signing Certificate Alias field to the 8205 version.
2. Added the Encryption Certificate Alias field to the 8205 version.
3. Added the SSL/TLS Certificate Alias field to the 8205 version.

The values assigned to these three fields are taken from those generated for these fields in the Service Provider (SP) Metadata Generation dialog box.

4. Relocated the Require Signed Artifact Resolution Requests sent to the IDP check box from the Service Provider (SP) tab in the 8204 version to this tab in the 8205 version.
5. Added the Enables support for Unsolicited Responses check box to this tab in the 8205 version.

## Advanced Tab

The change to the Advanced tab is shown in the following image:

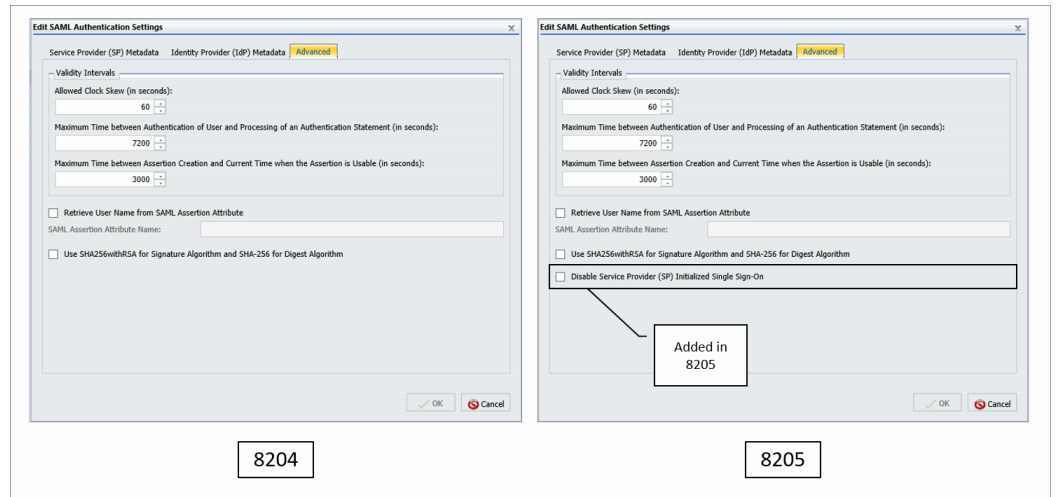

1. Added the Disable Service Provider (SP) Initialized Single Sign-On check box to the 8205 version



## Service Provider (SP) Metadata Generation Dialog Box

(This dialog box opens when you click Generate Metadata from the Service Provider (SP) Metadata tab.)

Changes to the Service Provider (SP) Metadata Generation dialog box are shown in the following image:

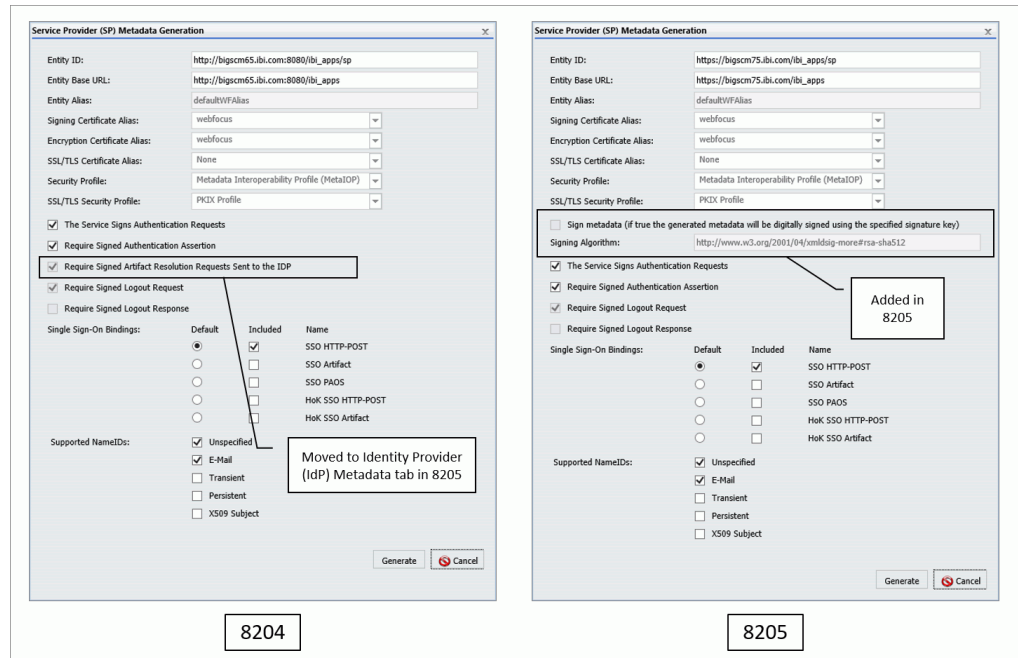

1. Removed the Require Signed Artifact Resolution Requests Sent to the IDP check box in the 8205 version.
2. Added the Sign metadata (If true the generated metadata will be digitally signed using the specified signature key) check box and the Signing Algorithm field, which identifies the URL of the Signing Algorithm selected for the signature key to the 8205 version.

This change replaces the check box with a link to the digital signing algorithm. (The check box and its associated field are dimmed and unavailable in this dialog box.)

- ❑ In WebFOCUS Release 8205, a new Distribution Directories folder appears in the Navigation tree of the Administration Console Configuration tab. This folder and the Distribution Directory configuration nodes listed within it replace the list of name-value pairs that appear in the File System Distribution Directories setting in versions prior to Release 8205. In the new version, this setting and any values assigned to it are removed from the Application Directories page of the Administration Console Configuration tab.

If you previously configured a list of file system distribution directories using this setting, these values will be converted into nodes under the Distribution Directory folder during the installation.

- ❑ In WebFOCUS Release 8205, log file entries for WARN, ERROR, and FATAL events are highlighted as follows:

- ❑ **WARN.** Yellow

- ❑ **ERROR.** Orange

- ❑ **FATAL.** Coral

In previous releases, these log file entries were not highlighted. The new highlights make it easier to identify log file entries that capture errors or problem events. The new highlights are applied by the log file viewer and appear only when you open and review log files from the Log Files page. They are not saved in zipped copies of the log files, and they do not appear when you open and review log files in a different text editor.

## WebFOCUS Language

The following are release considerations and product changes for the WebFOCUS reporting language.

### HTML Report Output

When HTML report output is wider than the size of the output window, the browser takes control and automatically adjusts the width of the report columns, so the output fits the screen width.

For example, run the following procedure and note how the SQUEEZE=1 setting is not respected in the report output:

```
TABLE FILE wf_retail
SUM WF_RETAIL.WF_RETAIL_SALES.COGS_US
WF_RETAIL.WF_RETAIL_SALES.QUANTITY_SOLD
WF_RETAIL.WF_RETAIL_SALES.GROSS_PROFIT_US
WF_RETAIL.WF_RETAIL_SALES.REVENUE_US
BY WF_RETAIL.WF_RETAIL_GEOGRAPHY_STORE.BUSINESS_REGION
BY WF_RETAIL.WF_RETAIL_GEOGRAPHY_STORE.BUSINESS_SUB_REGION
BY WF_RETAIL.WF_RETAIL_PRODUCT.PRODUCT_CATEGORY
BY WF_RETAIL.WF_RETAIL_PRODUCT.PRODUCT_SUBCATEG
BY WF_RETAIL.WF_RETAIL_PRODUCT.MODEL
BY WF_RETAIL.WF_RETAIL_PRODUCT.PRODUCT_NAME
ON TABLE PCHOLD FORMAT HTML
ON TABLE NOTOTAL
ON TABLE SET STYLE *
INCLUDE=IBFS:/FILE/IBI_HTML_DIR/ibi_themes/Warm.sty,$
TYPE=DATA, COLUMN=PRODUCT_NAME, SQUEEZE=1, WRAP=OFF, $
ENDSTYLE
END
```

The output is:

PAGE 1					
Store Business Region	Store Business Sub Region	Product Category	Product Subcategory	Model	Product Name
EMEA	Africa	Accessories	Charger	B00D7MOHDO	Samsung OEM 2.0 Amp Travel Charger
				BCG34HRE4KN	Cycle Energy Quick with Refresh Charger
			Headphones	Pioneer HDJ1000	Pioneer HDJ1000 Pro DJ Quality Stereo Headphones
				Sennheiser HD650	Sennheiser HD650 Stereo Headphone
				Sennheiser SET830S	Sennheiser SET830-S InfraRed Stereo TV Listening System
			Universal Remote Controls	Logitech 900	Logitech 915000030 Harmony 900 Universal Remote
		Camcorder	Handheld	JVC GCFM2BUS	JVC PICSIO GC-FM2BUS HD Pocket Camcorder - Black
				Panasonic HMTA1PPR	Panasonic HM-TA1 High Definition Mobile Camera - Red - HM-TA1PP-R
				Sanyo VPCCG20BK	Sanyo VPC-CG20BK Full HD 1080 Video & 10MP Digital Photos Camcorder
				Sanyo VPCPD2BK	Sanyo VPC-PD2BK HD Pocket Movie Dual Camcorder - Black
				Sony MHSCM5V	Sony MHS-CM5/V bloggie Pocketable HD Camera with 5x Optical Zoom
			Standard	Canon HFR11	Canon VIXIA HF R11 High Definition 32GB Dual Flash Memory Camcorder
				JVC GZHD620B	JVC HD Camcorder Black
				Sony DCRDVD650	Sony DCR-DVD650 Hybrid DVD Handycam Camcorder

As of Release 8205.07, you can control the width of HTML report columns using SQUEEZE=*n* or WRAP=*n*.

For example, running the same procedure with the TYPE=DATA, **COLUMN=PRODUCT\_NAME**, SQUEEZE=1, WRAP=OFF StyleSheet syntax produces the following report output:

PAGE 1								
Store Business Region	Store Business Sub Region	Product Category	Product Subcategory	Model	Product Name	Cost of Goods	Quantity Sold	Gross Profit
EMEA	Africa	Accessories	Charger	B00D7MOHDO	Samsung OEM...	\$23.00	1	\$27.00
				BCG34HRE4KN	Cycle Energy...	\$64.00	4	\$43.96
			Headphones	Pioneer HDJ1000	Pioneer HDJ10...	\$240.00	3	\$267.00
				Sennheiser HD650	Sennheiser HD...	\$1,140.00	3	\$359.85
				Sennheiser SET830S	Sennheiser SE...	\$435.00	5	\$410.00
			Universal Remote Controls	Logitech 900	Logitech 91500...	\$597.00	3	\$302.97
		Camcorder	Handheld	JVC GCFM2BUS	JVC PICSIO G...	\$82.00	1	\$79.10
				Panasonic HMTA1PPR	Panasonic HM-...	\$92.00	1	\$77.95
				Sanyo VPCCG20BK	Sanyo VPC-C...	\$360.00	4	\$323.96
				Sanyo VPCPD2BK	Sanyo VPC-PD...	\$60.00	1	\$67.49
				Sony MHSCM5V	Sony MHS-CM...	\$261.00	3	\$204.40
				Canon HFR11	Canon VIXIA H...	\$1,000.00	2	\$398.00
			Standard	JVC GZHD620B	JVC HD Camc...	\$489.00	1	\$160.95

## Prefix Operators PCT., RPCT., and PCT.CNT

In prior releases, by default, columns displayed as a result of the PCT., RPCT., and PCT.CNT prefix operators were displayed using the format of the original field, including any currency symbols associated with the format of the original field. Starting in this release, those columns will display with a percent sign (%), and the currency symbol will be removed.

This change in behavior is a result of the following SET command.

```
SET PCTFORMAT = {OLD|PERCENT}
```

where:

OLD

Does not remove currency symbols or add a percent sign.

PERCENT

Removes currency symbols and add a percent sign. It also enables you to reformat these fields. This is the default value.

PCT.CNT.*field* will always display with two decimal places, unless reformatted. For PCT.*field* and RPCT.*field*, if the original field has a:

- ☐ Precision-based format (F, D, M, X), the column will display with two decimal places.
- ☐ Packed format, the column will display with its original number of decimal places.
- ☐ Integer format, the column will display with no decimal places.

### DATEFNS Parameter

The value ON for the DATEFNS parameter activates year 2000-compliant versions of date functions. As of this release, the OFF value is no longer functional and operates as ON.

### Limit on Objects Removed

The limit of 128 objects, text items, or embedded fields placed in a heading, footing, subhead, or subfoot for styled and non-styled formats has been removed.





## Feedback

*Customer success is our top priority. Connect with us today!*

---

Information Builders Technical Content Management team is comprised of many talented individuals who work together to design and deliver quality technical documentation products. Your feedback supports our ongoing efforts!

You can also preview new innovations to get an early look at new content products and services. Your participation helps us create great experiences for every customer.

To send us feedback or make a connection, contact Sarah Buccellato, Technical Editor, Technical Content Management at [Sarah\\_Buccellato@ibi.com](mailto:Sarah_Buccellato@ibi.com).

To request permission to repurpose copyrighted material, please contact Frances Gambino, Vice President, Technical Content Management at [Frances\\_Gambino@ibi.com](mailto:Frances_Gambino@ibi.com).



# WebFOCUS

WebFOCUS Release Guide  
Release 8205.16

DN4501643.0519



**Information  
Builders**

Information Builders, Inc.  
Two Penn Plaza  
New York, NY 10121-2898